

30th January 2017

Dear Councillor,

Town Development Committee
Monday 6th February 2017 at 7.00pm

Committee Membership: Councillors Fraser (Chair) (West), Fryer (Vice Chair) (West), Cullen (Broadway), Davis (East), Dombowski (East), Humphries (Broadway) and Macdonald (East) External representatives: Tony Nicklin, Bill Parks and Len Turner Copied to all other members for information.

Your presence is requested at a meeting of the above committee to be held at Warminster Civic Centre, Sambourne Road, Warminster.

Yours sincerely,



Heather Abernethie FILCM
Town Clerk

Members of the public are welcome to attend meetings of the Council and Committees, unless excluded due to the confidential nature of the business.

A G E N D A

1. Apologies

- a) **To receive** apologies from those unable to attend.
- b) **To consider for acceptance** those apologies received with reasons for absence.

2. Minutes

- a) **To approve** as a correct record, the minutes of the Town Development Committee meeting held on Monday 5th December 2016; copies of these minutes have been circulated and Standing Order 17a provides that they may therefore be taken as read.
- b) **To note** any matters arising from the minutes of the Town Development Committee meeting held on Monday 5th December 2016.

3. Declarations of Interest

To receive any declarations of interest under Warminster Town Council's Code of Conduct issued in accordance with the Localism Act 2011.

4. Chairman's Announcements

To note any announcements made by the Chair.

Standing Orders will be suspended to allow for public participation.

5. Public Participation

- a) **To enable** members of the public to address the Council with an allowance of three minutes per person regarding any item on the agenda.
- b) **To receive** any petitions and deputations

Standing Orders will be reinstated following public participation

6. Reports from Unitary Authority Members

To note reports provided.

7. New Working Group

The committee agreed on 5th December 2016 to form a small continuation group of the Neighbourhood Plan Working Group to draw up a list of the key principles from the Neighbourhood Plan, including the policies and Community Actions, to provide support to the Planning Advisory Committee when considering planning applications. Nine of the original group have come forward to offer their assistance.

Members to agree the following:

- a) Name of the new group
- b) Councillor Sue Fraser must be a member as per the regular TOR's outline.
- c) Agree the membership

8. Boreham Road Traffic Speed Results.

Members to receive for the second time the road traffic speed survey results, reference minute 255/16, for discussion.

255/16 Boreham Road Traffic Speed Results

The results of the speed survey indicated that the criteria had been met for Community Speed Watch. Members asked for this item to be deferred until the next meeting as it had been raised by Councillor Macdonald who was not present.

9. West Street

Members to discuss notes from the meeting held on 9th December between officers and residents. **Members to instruct** the Clerk on a response to the CATG on their preferences for taking this issue forward.

10. The Close

Members to discuss the potential scheme outlined in the attached email and scheme drawing. The Clerk has met with affected business owners and has received support for the proposals. **Members to instruct** the Clerk on a response to the CATG.

11. Woodcock Road Metro Count

Members to receive metro count results for Woodcock Road. Members to instruct the Clerk for communication to the next CATG.

12. War Memorial

Members to note that Historic England is considering the War Memorial at Portway for addition to the List of Buildings of Special Architectural or Historic Interest and will send a report to Council, once completed. The Clerk will update members at a future date.

13. Warminster Vintage Bus Day

Members to agree the provision of 118 car parking spaces in Central Car park to support Warminster Vintage Bus Day on 1st October 2017. The Council is provided with 812 free spaces for the year.

14. WR1 Plants Green

Members to note WR1 for Plants Green has been included in current round of Waiting Restrictions under assessment. The Chair and Clerk agreed the scheme with residents and yellow lining will be extended on both sides of the road to the end of numbers 3 and 10. Residents have written to Council their support. The Clerk will provide a scheme map for members at the meeting.

15. Communications

- a) **The members to decide** on items requiring a press release.
- b) **The members to confirm** their spokesperson for any item listed on the agenda to report on the Council's decision if required.

The date of the next Town Development meeting - not yet booked.

The dates of the next two CATG meetings are 29th March 2017 and 15th June 2017.

Minutes from this meeting will be available to all members of the public either from our web site www.warminster-tc.gov.uk or by contacting us at Warminster Civic Centre.

THIS PAGE LEFT BLANK

Thursday, 26 January 2017

Traffic Speed Survey Result Boreham Road Warminster (30mph Speed Limit)

- Between Hersonslade and yew Tree

The Results of the survey for the area of Boreham Road are provided below.

The survey was carried out between 25/09/2016 and 07/10/2016. A total of 41668 vehicles were checked. The 85th percentile was 36.2mph (the 85th percentile is the speed at which 85% of the traffic is travelling at or below). The average speed was 31.6mph.

As with every other department, we have to target our limited resources to where they will be most effective and as such I would remind you that unless there are exceptional circumstances we will not accept another count request for this location or close surrounding area for another 12 months.

Community Speed Watch does not operate in any speed limit above 40mph.

In a 30mph speed limit the following criteria will be applied;

30 to 35mph 85th percentile = No Further Action (NFA)

35.1 to 42 mph 85th percentile = eligible for Community Speed Watch

Over 42 mph 85th percentile = Subject to Police enforcement

Any other results in higher speed limits will be discussed on their individual basis and merit.

Yours sincerely

Road Safety Driving
roadsafetydriving@wiltshire.gov.uk
01225 701970

THIS PAGE LEFT BLANK

Report on West Street Meeting on 9th December 2016

Present: Cllr Sue Fraser, Cllr Rob Fryer, Martin Rose from Wiltshire Council Highways, Caroline and husband, and their neighbour from 100 West Street

Discussion was had regarding the possible solutions to the problem of Traffic in West Street speeding, mounting the pavement to avoid on coming traffic and, also large HGV's trying to squeeze through parked cars. Martin suggested speaking to Mark Stansby regarding HGV Preferred Entry signs such as "For the Town Centre follow this sign" signage on other entrances into Warminster from the A350. Other signage could be "Narrow Road" signs around the Luxfield Road area and "Vehicle in Middle of Road" or "Single Line Traffic" signs.

It was then discussed as to the possibility of raising the kerb out side 100 and 102 West Street but Martin thought that the best solution would be Bollards on the edge of the pavement (preferably metallic) that collapse when hit and bounce back up afterwards. Also a solid white line on the road to highlight the edge of the carriage way and the footpath.

The white lining and the Bollards would cost approximately £3.5k of which the Town Council would have to pay 25%. We need to present these suggestions to the next Town Development Meeting to get it approved and referred to the next CATG meeting so that it can be put forward as one of the first projects for the new budget for April 2017.

THIS PAGE LEFT BLANK

Heather Abernethie

From: Rose, Martin <martin.rose@wiltshire.gov.uk>
Sent: 01 December 2016 12:03
To: Heather Abernethie
Subject: FW: The Close Warminster

Categories: Town Development

Hi Heather,

I'm currently looking at options for improvement to the footway at the Close. You will recall our recent site meeting with the owner of the Prestbury sports bar. As you know the footway is very narrow on western side and in some places it's little more than 1.0m wide.

The biggest area of concern is outside the old fire station where the narrow width and dropped kerb results in a cross gradient of some 9% (1 in 11). We normally try to avoid anything steeper than 8% (1 in 12) as this can cause discomfort for pedestrians and a low risk of wheel chairs/ mobility scooter tipping over.

One option for consideration is to widen the footway to 1.5m, remove the low kerb and replace with a new one at an upstand of 80-100mm. This gives us a cross gradient of around 2%. (1 in 50) See the area in question below. Do you think David McGirr would be agreeable to this? I only ask as if the old fire station suddenly becomes used by vehicles again we'll have a problem with the kerb height. If there is little chance this will happen, raising the kerb will make a real difference.

I would have liked to widen the footways past Kenegston court as these are around 1.0m wide, however this would affect our other issue for The Close, namely Vehicles encroaching onto the front of no.16. when trying to pass service vehicles delivering to the Prestbury sports bar (and others) The carriageway pinches down here so if I try to widen the path on the western side delivery vehicles would effectively block the road. (unless they park partially on the Footway). See 2nd screen print below.

I'd welcome any thoughts you may have on this in advance of next week's CATG.

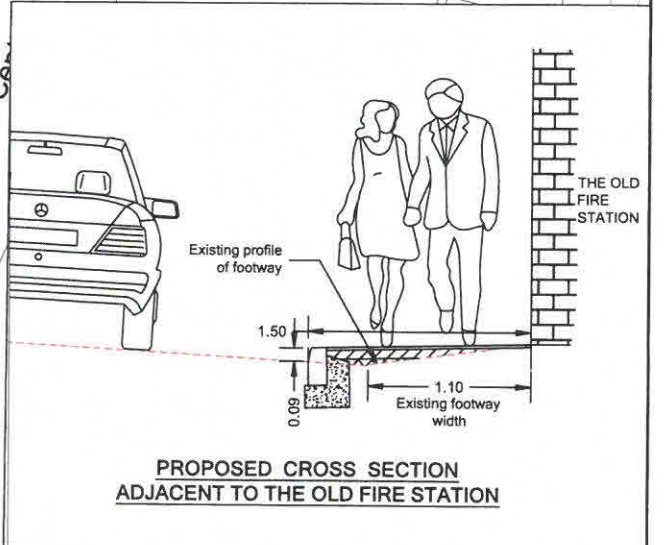
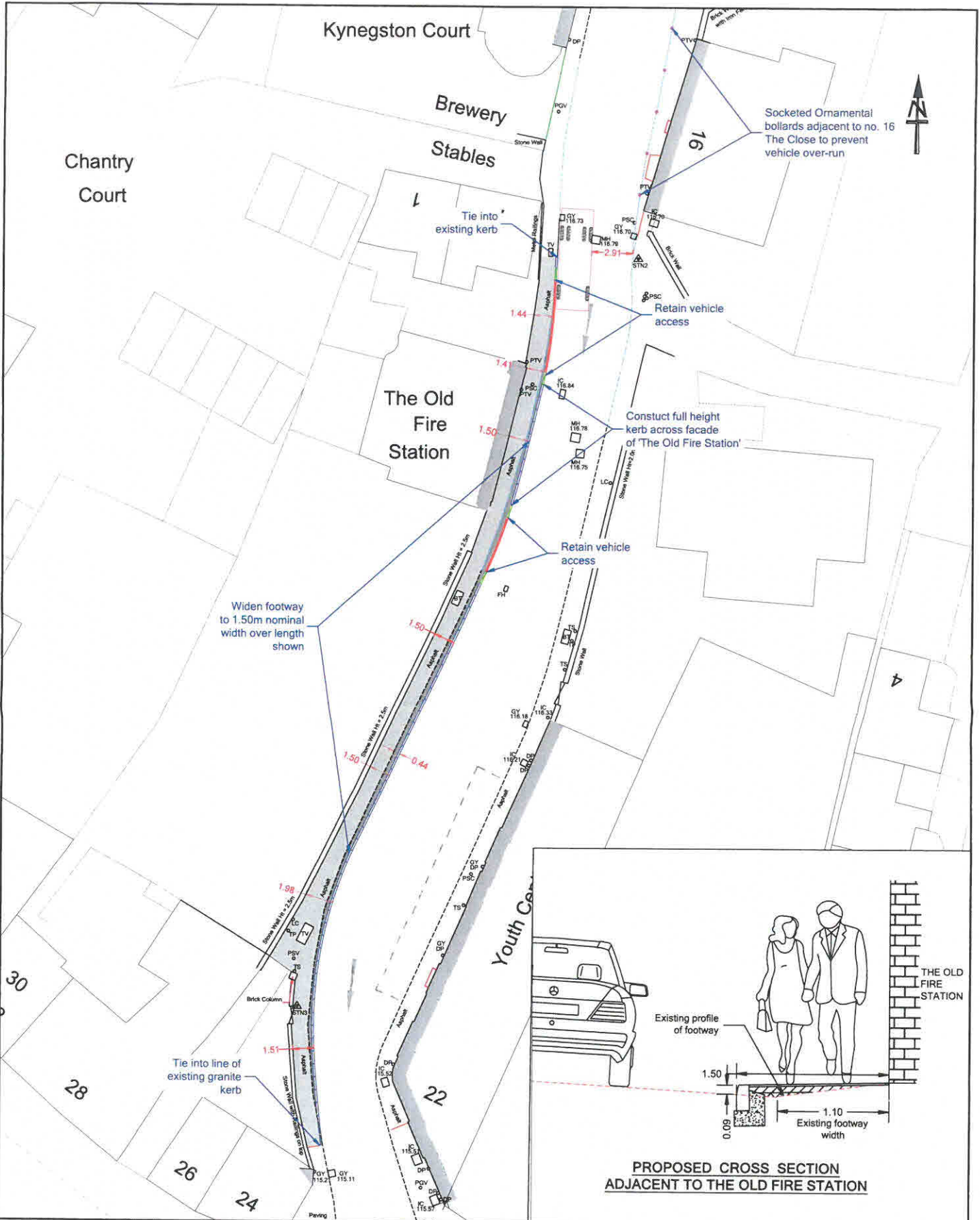

**PROPOSED CROSS SECTION
ADJACENT TO THE OLD FIRE STATION**

NOTES:

Wiltshire Council
Where everybody matters
Traffic & Network Management
County Hall, Bythesea Road, Trowbridge
Wiltshire, BA14 6JD
Tel: 0300 4560100
Website: www.wiltshire.gov.uk

This map is reproduced from Ordnance Survey material with the permission of Ordnance Survey on behalf of the Controller of Her Majesty's Stationary Office © Crown copyright.
Unauthorised reproduction infringes Crown Copyright and may lead to prosecution or Civil Proceedings.
Wiltshire Council (100049050) 2018

F					
E					
D					
C					
B					
A					
O	01/2018	MJR	GTR	DMT	ORIGINAL
REV	DATE	DRAWN	CHECK	APPROV	DESCRIPTION
DRAWING PURPOSE:					
DRAFT					

PROJECT:	
WARMINSTER CATG THE CLOSE	
DRAWING TITLE:	
PROPOSED FOOTWAY IMPROVEMENTS OUTLINE DESIGN OPTION A	
SCALES:	1:250
DRAWING NO:	2016-050-MR-WARMINSTER-0001
FILE REF:	
SHEET SIZE:	A3
REVISION:	0

MetroCount Traffic Executive Speed Statistics

SpeedStat-587 -- English (ENG)

Datasets:

Site: [02621113-24] WOODCOCK RD <30MPH> EAST PF WHITEFIELD CL
Attribute: WILTSHIRE
Direction: 8 - East bound A>B, West bound B>A. **Lane:** 0
Survey Duration: 17:29 29 November 2016 => 10:25 14 December 2016,
Zone:
File: 02621113-24 0 2016-12-14 1027.EC0 (Plus)
Identifier: T454K8P5 MC56-L5 [MC55] (c)Microcom 19Oct04
Algorithm: Factory default axle (v4.06)
Data type: Axle sensors - Paired (Class/Speed/Count)

Profile:

Filter time: 17:30 29 November 2016 => 10:25 14 December 2016 (14.7053)
Included classes: 1, 2, 3, 4, 5, 6, 7, 8, 9, 10, 11, 12
Speed range: 5 - 100 mph.
Direction: North, East, South, West (bound), P = East
Separation: Headway > 4 sec, Span 0 - 100 metre
Name: Default Profile
Scheme: Vehicle classification (ARX)
Units: Part metric (metre, mi, m/s, mph, kg, tonne)
In profile: Vehicles = 62316 / 90083 (69.18%)

Speed Statistics

SpeedStat-587

Site: 02621113-24.0.1EW
Description: WOODCOCK RD <30MPH> EAST PF WHITEFIELD CL
Filter time: 17:30 29 November 2016 => 10:25 14 December 2016
Scheme: Vehicle classification (ARX)
Filter: Cls(1 2 3 4 5 6 7 8 9 10 11 12) Dir(NESW) Sp(5,100) Headway(>4) Span(0 - 100)

Vehicles = 62316

Posted speed limit = 30 mph, Exceeding = 21600 (34.66%), Mean Exceeding = 33.87 mph

Maximum = 91.5 mph, Minimum = 5.0 mph, Mean = 28.3 mph

85% Speed = 33.1 mph, 95% Speed = 37.1 mph, Median = 28.2 mph

10 mph Pace = 23 - 33, Number in Pace = 44228 (70.97%)

Variance = 31.92, Standard Deviation = 5.65 mph

Speed Bins (Partial days)

Speed	Bin	Below		Above		Energy	vMult	n * vMult
0 - 5	0	0	0.0%	62316	100.0%	0.00	0.00	0.00
5 - 10	357	357	0.6%	61959	99.4%	0.00	0.00	0.00
10 - 15	809	1166	1.9%	61150	98.1%	0.00	0.00	0.00
15 - 20	2376	3542	5.7%	58774	94.3%	0.00	0.00	0.00
20 - 25	11059	14601	23.4%	47715	76.6%	0.00	0.00	0.00
25 - 30	26115	40716	65.3%	21600	34.7%	0.00	0.00	0.00
30 - 35	15809	56525	90.7%	5791	9.3%	0.00	0.00	0.00
35 - 40	4304	60829	97.6%	1487	2.4%	0.00	0.00	0.00
40 - 45	996	61825	99.2%	491	0.8%	0.00	0.00	0.00
45 - 50	312	62137	99.7%	179	0.3%	0.00	0.00	0.00
50 - 55	116	62253	99.9%	63	0.1%	0.00	0.00	0.00
55 - 60	36	62289	100.0%	27	0.0%	0.00	0.00	0.00
60 - 65	15	62304	100.0%	12	0.0%	0.00	0.00	0.00
65 - 70	6	62310	100.0%	6	0.0%	0.00	0.00	0.00
70 - 75	4	62314	100.0%	2	0.0%	0.00	0.00	0.00
75 - 80	1	62315	100.0%	1	0.0%	0.00	0.00	0.00
80 - 85	0	62315	100.0%	1	0.0%	0.00	0.00	0.00
85 - 90	0	62315	100.0%	1	0.0%	0.00	0.00	0.00
90 - 95	1	62316	100.0%	0	0.0%	0.00	0.00	0.00
95 - 100	0	62316	100.0%	0	0.0%	0.00	0.00	0.00

Total Speed Rating = 0.00

Total Moving Energy (Estimated) = 0.00

Speed limit fields (Partial days)

Limit	Below	Above
0 30 (PSL)	40716 65.3%	21600 34.7%

MetroCount Traffic Executive Speed Statistics

SpeedStat-587 -- English (ENG)

Datasets:

Site: [02621113-24] WOODCOCK RD <30MPH> EAST PF WHITEFIELD CL
Attribute: WILTSHRIE
Direction: 8 - East bound A>B, West bound B>A. Lane: 0
Survey Duration: 17:29 29 November 2016 => 10:25 14 December 2016,
Zone:
File: 02621113-24 0 2016-12-14 1027.EC0 (Plus)
Identifier: T454K8P5 MC56-L5 [MC55] (c)Microcom 19Oct04
Algorithm: Factory default axle (v4.06)
Data type: Axle sensors - Paired (Class/Speed/Count)

Profile:

Filter time: 17:30 29 November 2016 => 10:25 14 December 2016 (14.7053)
Included classes: 1, 2, 3, 4, 5, 6, 7, 8, 9, 10, 11, 12
Speed range: 5 - 100 mph.
Direction: North, East, South, West (bound), P = East
Separation: Headway > 4 sec, Span 0 - 100 metre
Name: Default Profile
Scheme: Vehicle classification (ARX)
Units: Part metric (metre, mi, m/s, mph, kg, tonne)
In profile: Vehicles = 62316 / 90083 (69.18%)

Speed Statistics

SpeedStat-587

Site: 02621113-24.0.1EW
Description: WOODCOCK RD <30MPH> EAST PF WHITEFIELD CL
Filter time: 17:30 29 November 2016 => 10:25 14 December 2016
Scheme: Vehicle classification (ARX)
Filter: Cls(1 2 3 4 5 6 7 8 9 10 11 12) Dir(NESW) Sp(5,100) Headway(>4) Span(0 - 100)

Vehicles = 62316
Posted speed limit = 30 mph, Exceeding = 21600 (34.66%), Mean Exceeding = 33.87 mph
Maximum = 91.5 mph, Minimum = 5.0 mph, Mean = 28.3 mph
85% Speed = 33.1 mph, 95% Speed = 37.1 mph, Median = 28.2 mph
10 mph Pace = 23 - 33, Number in Pace = 44228 (70.97%)
Variance = 31.92, Standard Deviation = 5.65 mph

Speed Bins (Partial days)

Speed	Bin	Below	Above	Energy	vMult	n * vMult
0 - 5	0	0.0%	62316 100.0%	0.00	0.00	0.00
5 - 10	357	0.6%	61959 99.4%	0.00	0.00	0.00
10 - 15	809	1.3%	61150 98.1%	0.00	0.00	0.00
15 - 20	2376	3.8%	58774 94.3%	0.00	0.00	0.00
20 - 25	11059	17.7%	47715 76.6%	0.00	0.00	0.00
25 - 30	26115	41.9%	21600 34.7%	0.00	0.00	0.00
30 - 35	15809	25.4%	5791 9.3%	0.00	0.00	0.00
35 - 40	4304	6.9%	1487 2.4%	0.00	0.00	0.00
40 - 45	996	1.6%	491 0.8%	0.00	0.00	0.00
45 - 50	312	0.5%	179 0.3%	0.00	0.00	0.00
50 - 55	116	0.2%	63 0.1%	0.00	0.00	0.00
55 - 60	36	0.1%	27 0.0%	0.00	0.00	0.00
60 - 65	15	0.0%	12 0.0%	0.00	0.00	0.00
65 - 70	6	0.0%	6 0.0%	0.00	0.00	0.00
70 - 75	4	0.0%	2 0.0%	0.00	0.00	0.00
75 - 80	1	0.0%	1 0.0%	0.00	0.00	0.00
80 - 85	0	0.0%	1 0.0%	0.00	0.00	0.00
85 - 90	0	0.0%	1 0.0%	0.00	0.00	0.00
90 - 95	1	0.0%	0 0.0%	0.00	0.00	0.00
95 - 100	0	0.0%	0 0.0%	0.00	0.00	0.00

Total Speed Rating = 0.00
Total Moving Energy (Estimated) = 0.00

Speed limit fields (Partial days)

Limit	Below	Above
0 30 (PSL)	40716 65.3%	21600 34.7%

RECEIVED

01985 215666
margord@hotmail.com

16 JAN 2017

6 Plants Green
Warminster
Wiltshire
BA12 9NN

Warminster Town Council
Sambourne Road
Warminster
BA12 8LB

15.1.2017

Dear Heather

Re WR1 request Form for Plants

Following our meeting of 5.1.2017 the plan drawn up by Wiltshire Council's Traffic and Network Management Team along with a covering letter has been circulated to the residents of Plant's Green.

No objections have been raised.

The householders of numbers 10 and 3 request that the extension of the yellow lines run to the end of their properties to allow maximum visibility on the S Bends.

Thank you for your continuing assistance.

Yours sincerely



Margaret MacDonald